

Hampshire Country Club Planned Residential Development
Village of Mamaroneck,
Westchester County, New York
Final Environmental Impact Statement

Wetland Water Budget Analysis

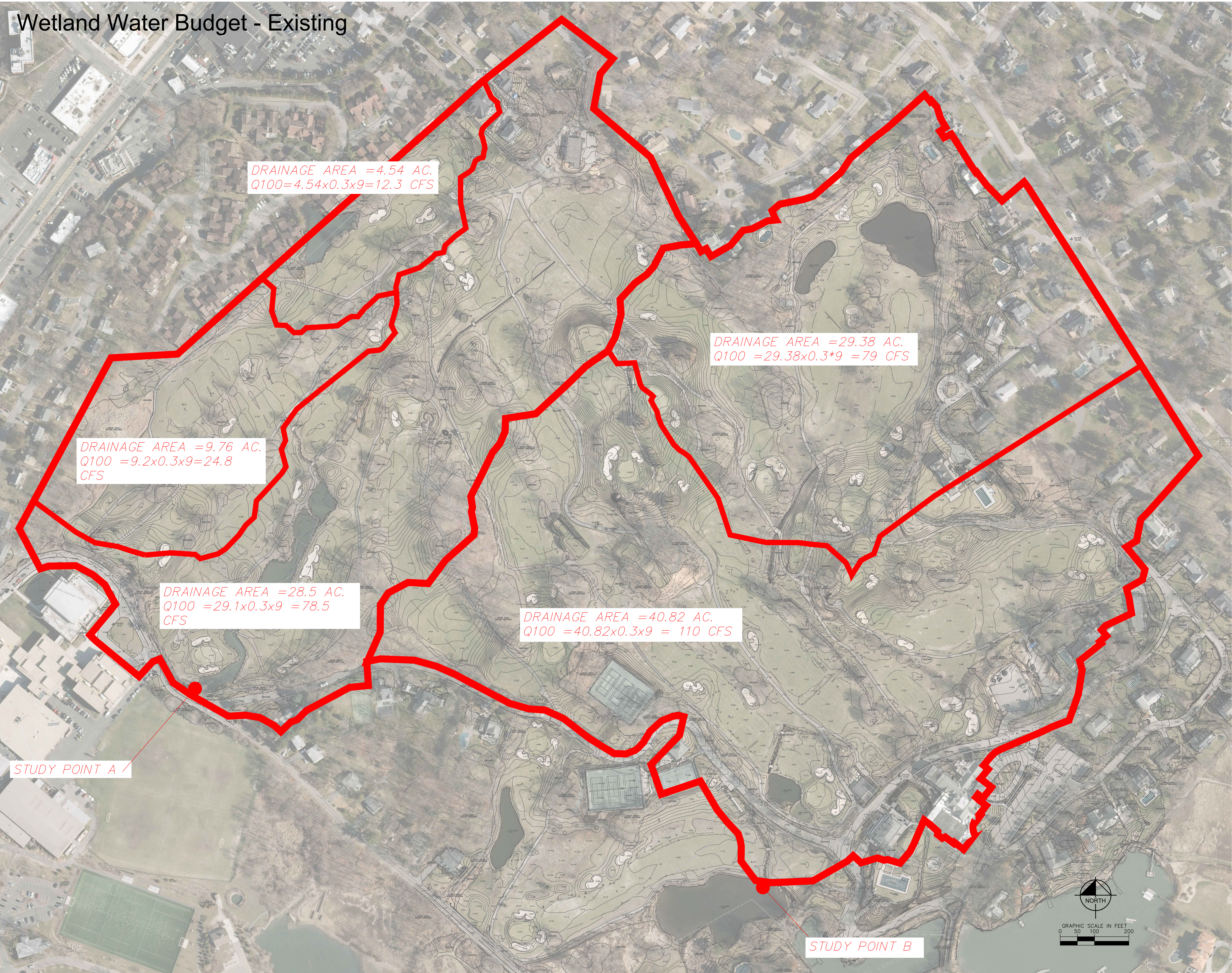

Wetland Water Budget - Existing



Wetland Water Budget - Proposed

DRAINAGE AREA = 4.99 AC.
 $Q_{100} = 4.99 \times 0.3 \times 9 = 13.5 \text{ CFS}$

DRAINAGE AREA = 27.31 AC.
 $Q_{100} = 27.31 \times 0.32 \times 9 = 78.7 \text{ CFS}$

DRAINAGE AREA = 8.36 AC.
 $Q_{100} = 8.36 \times 0.3 \times 9 = 22.6 \text{ CFS}$

DRAINAGE AREA = 27.15 AC.
 $Q_{100} = 27.15 \times 0.32 \times 9 = 78 \text{ CFS}$

DRAINAGE AREA = 45.19 AC.
 $Q_{100} = 45.19 \times 0.352 \times 9 = 143 \text{ CFS}$

STUDY POINT A

STUDY POINT B

